

The SVF Series R9 Ball Valves feature a high performance design for use in critical, process-quality applications. These valves exceed the pressure & temperature ratings of traditional, general purpose ball valves.

SERIES R9 DESIGN FEATURES

- ✓ High performance design for process-quality applications
- ✓ Encapsulated body seals to facilitate welding without disassembly
- ✓ Live-loaded stem packing ensures seal-tight pressure containment even under thermal cycling
- ✓ Three-piece design offers easy access for in-line maintenance
- ✓ ISO 5211 mounting pad for easy "Direct Mount" actuation
- ✓ Standard seat material is TFM1600™
- ✓ Blowout proof stem adds safety & reliability
- ✓ Lockable in the "Open" or "Closed" position
- ✓ Anti-Static stem device standard

MATERIALS OF CONSTRUCTION

ITEM	DESCRIPTION	MATERIALS SPECIFICATIONS
1	Body	316 Stainless Steel (ASTM A351-CF8M) Carbon Steel (ASTM A216-WCB)
2	End Connector	316L Stainless Steel (ASTM A351-CF3M) Carbon Steel (ASTM A216-WCB)
3	Ball	316 Stainless Steel (ASTM A351-CF8M)
4	Stem	316 Stainless Steel (AISI-316)
5	Seat	TFM1600™, Delrin®, PEEK
6	Body Seal	PTFE, Buna, Grafoil®
7	Stem Seal	PTFE

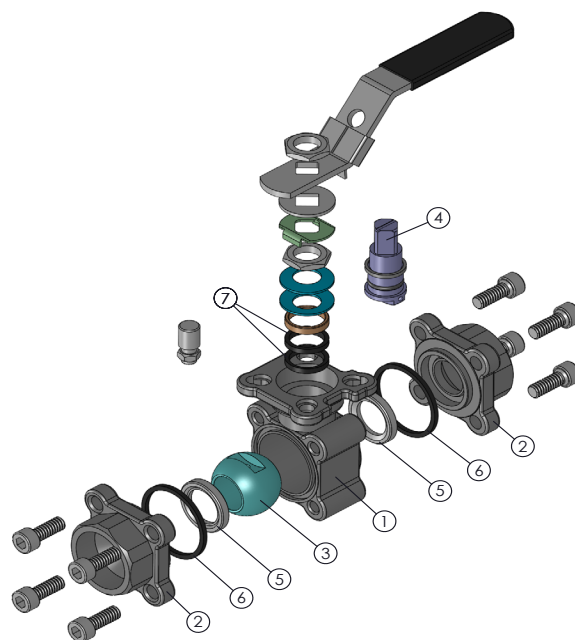

SERIES EZ-MAX FOR AUTOMATION

R9 valves feature direct mounting for pneumatic or electric automation. This feature reduces the cost and additional size and weight of valves requiring a mounting adapter kit.



What do you need today?™

HIGH PURITY
CleanFLOW®

PRO-SPEC
PROCESS SPECIFIC

QUALITY FLOWS
THROUGH US

DIMENSIONS, WEIGHT, Cv, TORQUE

Size	A		B		D		L		Weight		Cv	Torque*	
	in.	mm	in.	mm	in.	mm	in.	mm	lbs	kg		in-lbf	Nm
1/2"	2.36	60	0.50	12.7	4.61	117	2.09	53	1	0.54	8	44	5
3/4"	2.56	65	0.63	16	4.61	117	2.09	53	1	0.63	11	62	7
1"	2.95	75	0.79	20	5.00	127	3.19	81	2	1.00	21	106	12
1-1/2"	3.94	100	1.26	32	6.70	170	3.39	86	5	2.28	57	230	26
2"	4.33	110	1.50	38	7.17	182	3.39	86	8	3.75	80	300	34

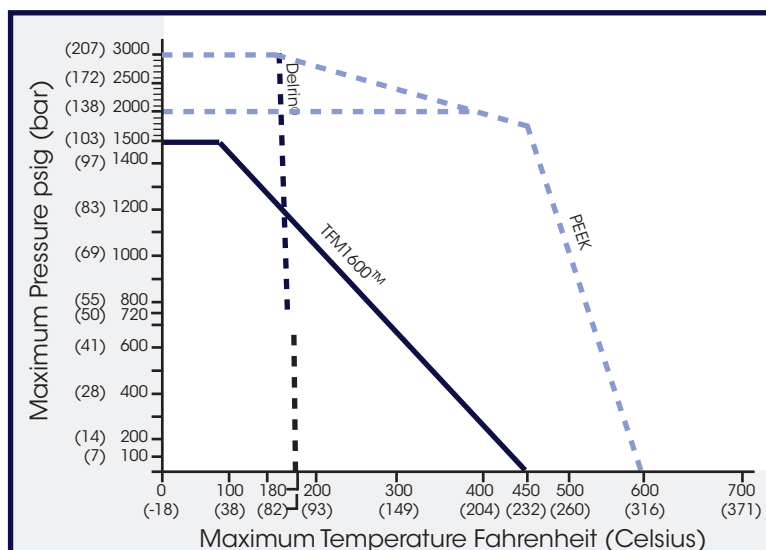
R9 - PRESSURE/TEMPERATURE CHART

* At full differential pressure for clean fluids with TFM1600™ Seats

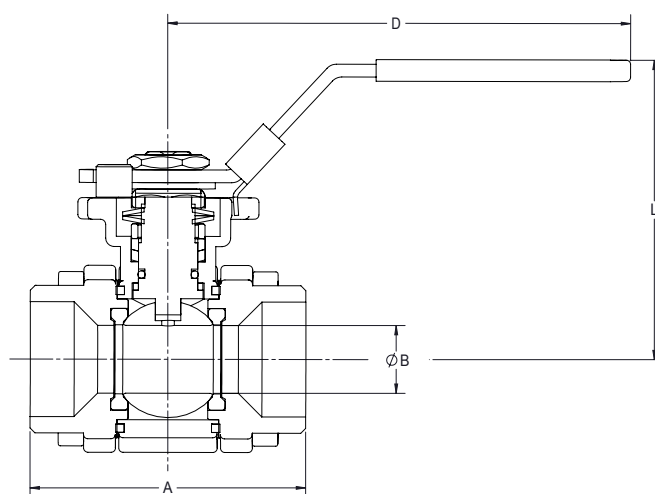
HOW TO ORDER SERIES R9 BALL VALVES

Please refer to the next page for our comprehensive
How to Order Guide for Series R9 Ball Valves.

Ordering Code Sequence (Columns 1 thru 11)

1	2	3	4	5	6
SERIES	BODY	ENDS	BALL	STEM	SEAT MATERIAL
R900	6 = 316 Stainless Steel ASTM A351- CF8M 4 = Carbon Steel ASTM A216 - WCB	6 = 316L Stainless Steel ASTM A351- CF3M 4 = Carbon Steel ASTM A216 - WCB	6 = 316 Stainless Steel ASTM A351- CF8M	6 = 316 Stainless Steel AISI 316	A = TFM1600™ D = Delrin K = PEEK

7	8	9	10	11
BODY SEAL	END CONNECTIONS	VALVE SIZE	OPTIONS*	SPECIAL SERVICES*
T = PTFE B = Buna G = Grafoil	SE0 = Screwed Ends (FNPT) SW0 = Socket Weld Ends	005 = 1/2" 007 = 3/4" 010 = 1" 015 = 1-1/2" 020 = 2"	00 = None	00 = None XC = Oxygen Cleaned SF = Degreased (Silicone Free) UH = Vent / Relief Hole ¹ AE = Oxygen Cleaned & Relief Hole ¹ AK = Degreased & Vent Hole ¹

Order Example: (R9006666ATSE00050000) The Part Number will contain 20 digits.

Ordering Code Sequence >>

Sample Part Number >>

1	2	3	4	5	6	7	8	9	10	11
R900	6	6	6	6	A	T	SE0	005	00	00
Valve Series	Body Material	End Material	Ball	Stem	Seat Material	Seat Material	End Connections	Valve Size	Options*	Special Services*

¹ Vent Hole is on the Upstream Side

* Not all Options or Special Services available on all ball valves. Consult SVF for additional information.