

The SVF Series R89 Ball Valve is part of our family of exotic alloy products designed for demanding applications. This process-quality, high performance valve engineered and manufactured to meet applications requiring all wetted metal parts to be Hastelloy or Alloy 20.

SERIES R88/89 DESIGN FEATURES

- ✓ Encapsulated body seals to facilitate welding without disassembly
- ✓ Live-loaded stem packing ensures seal-tight pressure containment even under thermal cycling
- ✓ Three-piece "swing out" design offers easy access for in-line maintenance
- ✓ ISO 5211 mounting pad for easy actuation
- ✓ Standard seat material is TFM1600™
- ✓ Blowout proof stem adds safety & reliability
- ✓ Full range of options to suit specific requirements

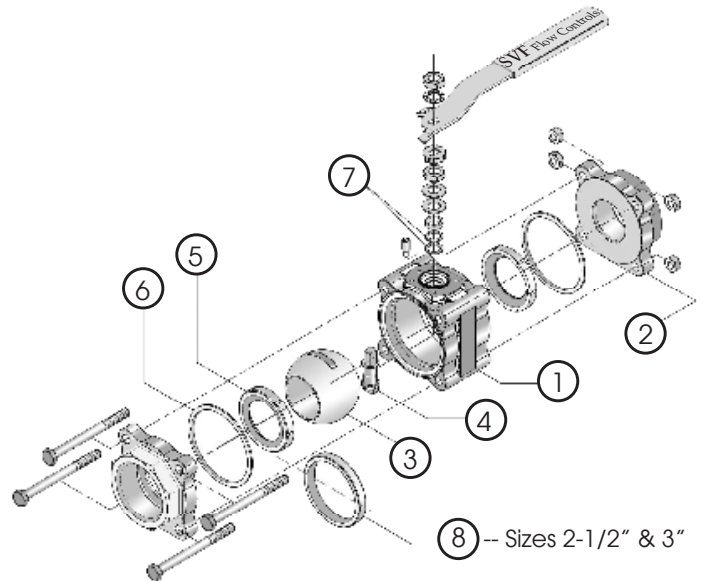

MATERIALS OF CONSTRUCTION

ITEM	DESCRIPTION	MATERIALS SPECIFICATIONS (Additional options available)
1	Body	Hastelloy (ASTM A494, CW-12MW) Alloy 20 (ASTM A351-CN7M)
2	End Connector	Hastelloy (ASTM A494, CW-12MW) Alloy 20 (ASTM A351-CN7M)
3	Ball	Hastelloy (ASTM A494, CW-12MW) Alloy 20 (ASTM A351-CN7M)
4	Stem	Hastelloy (ASTM A494, CW-12MW) Alloy 20 (ASTM A351-CN7M)
5	Seat	TFM1600™, Delrin®, UHMWPE, PEEK
6	Body Seal	PTFE, Buna "N", GRAFOIL®, UHMWPE, Viton®, EPDM
7	Stem Seal	SupraLon™ Alloy 20 (ASTM A351-SN7M)
8	Retainer Sizes 2-1/2" & 3"	Hastelloy (ASTM A494, CW-12MW) Alloy 20 (ASTM A351-SN7M)

R88/89 MEDIA APPLICATIONS

- Oxidizers such as ferric and cupric chlorides
- Hot contaminated media (organic and inorganic)
- Chlorine
- Formic and acetic acids
- Acetic anhydride
- Seawater and brine solutions
- Wet chlorine gas
- Hypochlorite and chlorine dioxide
- See our corrosion guide for more info

NOTE: Seat materials will limit some applications. Consult SVF for specific applications

What do you need today?™

HIGH PURITY VALVES
CleanFLOW

PRO-SPEC
PROCESS SPECIFIC

QUALITY FLOWS
THROUGH US

Size	A		B		D		L		Weight		Cv	Torque**	
	in.	mm	in.	mm	in.	mm	in.	mm	lbs	kg		in-lbf	Nm
1/4" *	2.60	66	0.44	11	5	127	1.8	46	2	0.9	3	45	5
3/8" *	2.60	66	0.44	11	5	127	1.8	46	2	0.9	5	45	5
1/2"	2.60	66	0.44	11	5	127	1.8	46	2	0.9	8	45	5
3/4"	2.81	71	0.56	14	5	127	1.9	48	2	0.9	12	45	5
1"	3.70	94	0.81	21	6	152	2.4	61	4	1.8	32	100	11
1-1/4"	4.25	108	1.00	25	6	152	2.6	66	5	2.3	57	130	15
1-1/2"	4.57	116	1.25	32	7	178	3.2	81	7	3.2	80	280	32
2"	5.04	128	1.50	38	7	178	3.3	84	11	5.0	104	360	41
2-1/2"	5.95	151	2.00	51	11	279	3.4	86	17	7.7	240	560	63
3"	6.68	170	2.50	64	14	356	7.3	185	30	13.6	320	1000	113

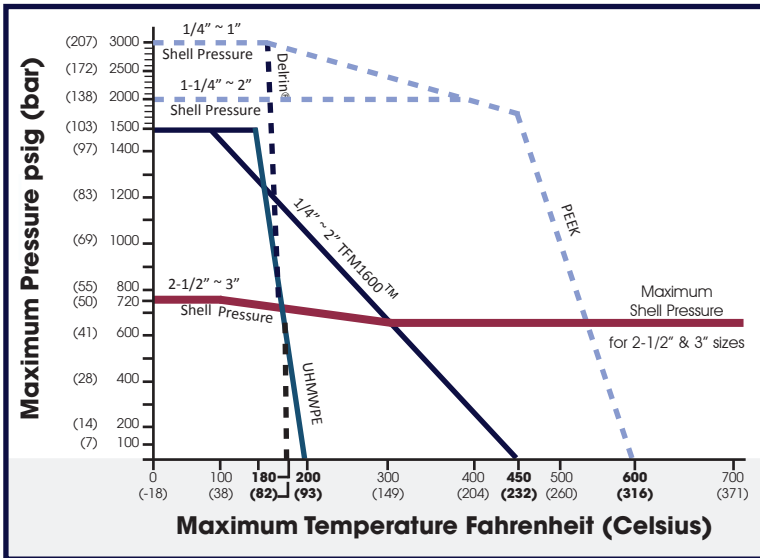
R88/89 - PRESSURE/TEMPERATURE CHART

* 1/4" and 3/8" are Full Port

** At full differential pressure for clean fluids with TFM1600™ Seats

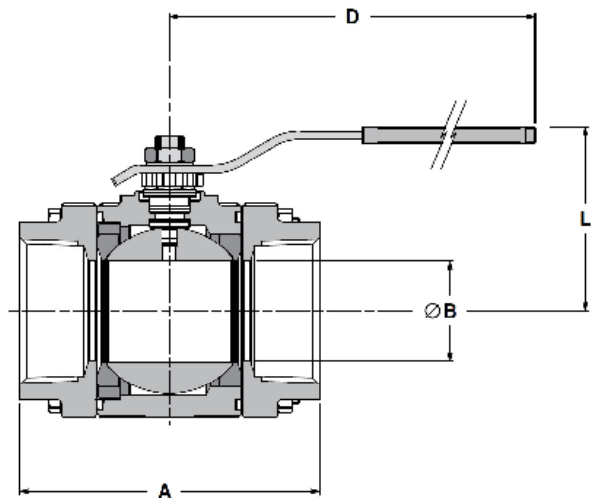
HOW TO ORDER SERIES R88/89 BALL VALVES

Please refer to the next page for our comprehensive How to Order Guide for Series R88/89 Ball Valves.

Ordering Code Sequence (Columns 1 thru 11)

1	2	3	4	5	6
SERIES	BODY	ENDS	BALL	STEM	SEAT MATERIAL
R800 =	8 = Alloy 20 (ASTM A351-CN7M) 9 = Hastelloy ASTM A494 CW12MW	8 = Alloy 20 (ASTM A351-CN7M) 9 = Hastelloy ASTM A494 CW12MW	8 = Alloy 20 (ASTM A351-CN7M) 9 = Hastelloy ASTM A494 CW12MW	8 = Alloy 20 (ASTM A351-CN7M) 9 = Hastelloy ASTM A494 CW12MW	A = TFM1600™ D = Delrin** (1/4" ~ 2") U = UHMWPE K = PEEK (1/4" ~ 2") S = SupraLon

7	8	9	10	11
BODY SEAL	END CONNECTIONS	VALVE SIZE	OPTIONS*	SPECIAL SERVICES*
T = PTFE B = Buna "N" G = GRAFOIL U = UHMWPE V = Viton E = EPDM S = SupraLon	SEO = Screwed Ends (FNPT) SWO = Socket Weld Ends BWO = Butt Weld Ends Schedule 40 wall (std) AAA = Screwed End X Socket Weld End AAB = Screwed End X Butt Weld (Sch-40) End	002 = 1/4" (Full Port) 003 = 3/8" (Full Port) 005 = 1/2" 007 = 3/4" 010 = 1" 012 = 1-1/4" 015 = 1-1/2" 020 = 2" 025 = 2-1/2" 030 = 3"	00 = None OH = Oval Handle LK = Locking Device SX = ISO Cast Stem Extension AD = Anti-Static Device SC = Secondary Containment AA = Oval Handle & Locking Device AB = Oval Handle & ISO Cast Stem Extension AC = Locking Device & Anti-Static Device AG = ISO Cast Stem Extension & Locking Device JA = Oval Handle, ISO Cast Stem Extension & Locking Device JB = Oval Handle, ISO Cast Stem Extension & Anti-Static Device JE = Locking Device, ISO Cast Stem Extension & Anti-Static Device	00 = None XC = Oxygen Cleaned SF = Degreased (Silicone Free) UH = Vent/Relief Hole¹ AS = Ammonia Service HC = High Cycle Stem Kit VV = Vacuum & Searching Gas Stem Kit AE = Oxygen Cleaned & Vent Hole ¹ AK = Degreased & Vent Hole¹ AU = Ammonia Service & High Cycle Stem Kit

Order Example: (R8009999ATSE00050000) The Part Number will contain 20 digits.

Ordering Code Sequence >>

Sample Part Number >>

1	2	3	4	5	6	7	8	9	10	11
R800	9	9	9	9	A	T	SEO	005	00	00



¹ Vent Hole is on the Upstream Side

* Not all Options or Special Services available on all ball valves. Consult SVF for additional information.

** Delrin Seats cannot be used for Oxygen Service