

The SVF Series H7 Code 62 Standard Port High-Pressure ball valve is designed to meet applications up to 6000 psi. This performance engineered valve features a Stainless Steel Body and is available in a variety of alloy materials. The H7 adds safety and reliability to CNG high pressure systems.

SERIES H7-62 DESIGN FEATURES

- ✓ High pressure to 6000 psi
- ✓ Live-loaded stem packing ensures seal-tight pressure containment even under thermal cycling
- ✓ Three-piece "swing out" design offers easy access for in-line maintenance
- ✓ Standard seat material is Delrin®
- ✓ Blowout proof stem adds safety & reliability
- ✓ Stainless Steel fasteners and handle

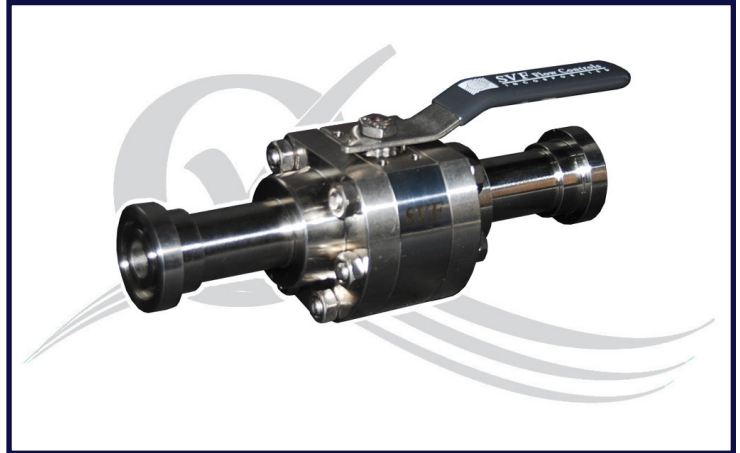

The Series H7-62 Ball Valve is available with additional options. Contact SVF for more information.

H7-62 MATERIALS OF CONSTRUCTION

ITEM	DESCRIPTION	MATERIALS SPECIFICATIONS (Additional options available)
1	Body	316 Stainless Steel (ASTM A351 CF8M)
2	End Connector	SW/SE Ends: 316L Stainless Steel (ASTM A351 CF3M) Code 62 Ends: 316 Stainless Steel (ASTM A351 CF8M)
3	Ball	316 Stainless Steel (ASTM A351 CF8M)
4	Stem	Stainless Steel 17-4 PH (ASTM A564 630)
5	Seat	Delrin®, PEEK
6	Body Seal	Buna "N", Viton®, EPDM
7	Stem Seal	SupraLon™

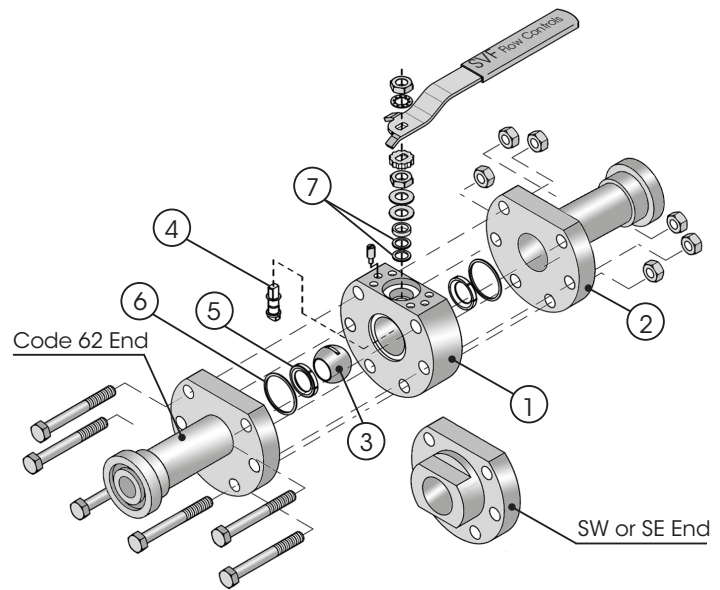

SPECIFICATION STANDARDS OF COMPLIANCE

SVF Series H7-62 Ball Valves are available in designs that meet the following Industry Standards:

- ANSI
- ASME
- API
- DIN
- ISO
- MSS
- BPE
- NACE
- ASTM

Contact SVF for specific applications

What do you need today?™

HIGH PURITY VALVES
CleanFLOW

PRO-SPEC
PROCESS SPECIFIC

QUALITY FLOWS
THROUGH US

DIMENSIONS, WEIGHT, CV, TORQUE

Size	End Connections	A		B		D		L		Cv	Weight		Torque*	
		in.	mm	in.	mm	in.	mm	in.	mm		lbs	kg	in-lbf	Nm
3/4"	Code 62 X Code 62 End	8.12	206	0.56	14	5	127	1.9	48	12	6.2	2.8	200	23
3/4"	Code 62 X SW/SE End	5.76	146	0.56	14	5	127	1.9	48	12	5.5	2.5	200	23
1"	Code 62 X Code 62 End	8.75	222	0.81	21	6	152	2.4	61	32	11.8	5.3	300	34
1"	Code 62 X SW/SE End	6.38	162	0.81	21	6	152	2.4	61	32	10.8	4.9	300	34

PRESSURE/TEMPERATURE CHART

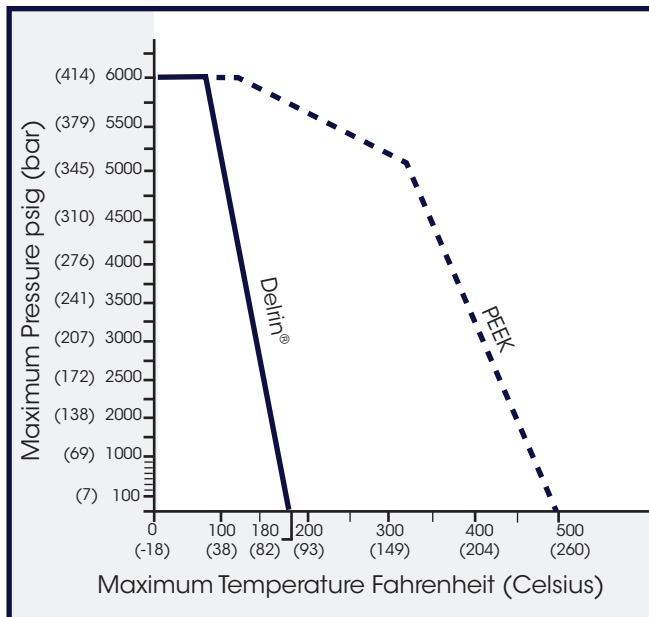

* At full differential pressure for clean fluids with Delrin® Seats

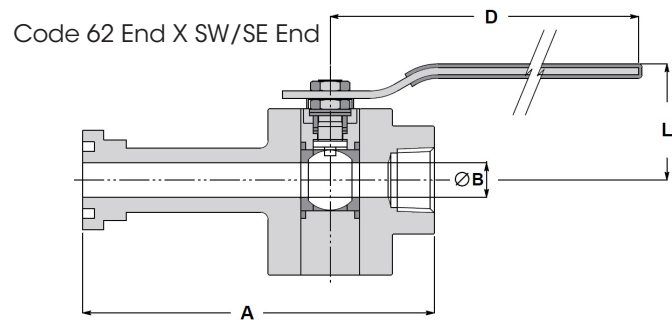
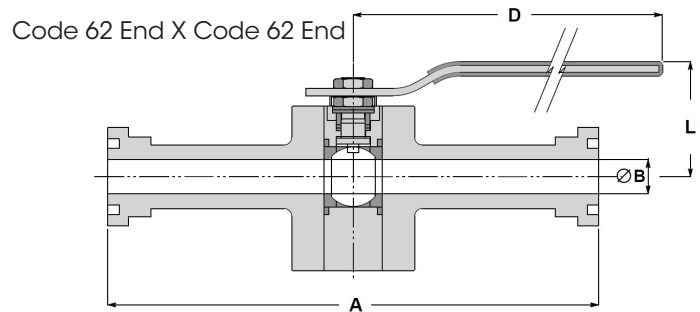

HOW TO ORDER SERIES H7-62 BALL VALVES

Please refer to the next page for our comprehensive How to Order Guide for Series H7-62 Ball Valves.

Ordering Code Sequence (Columns 1 thru 11)

1	2	3	4	5	6
SERIES	BODY	ENDS	BALL	STEM	SEAT MATERIAL
H700 = Series H7	6 = 316 Stainless Steel ASTM A351 CF8M	6 = 316 Stainless Steel ASTM A351: CF8M 316 = Code 62 Ends CF3M 316L = Screwed Ends Socket Weld Ends	6 = 316 Stainless Steel ASTM A351 CF8M	M = Stainless Steel 17-4 pH ASTM A564 630	D = Delrin** K = PEEK

7	8	9	10	11
BODY SEAL	END CONNECTIONS	VALVE SIZE	OPTIONS*	SPECIAL SERVICES*
B = Buna "N" V = Viton E = EPDM	UFA = Code 62 Ends AAH = Screwed End (FNPT) X Code 62 End (UFA) ABJ = Socket Weld End X Code 62 End (UFA)	007 = 3/4" 010 = 1"	00 = None LK = Locking Device AD = Anti-Static Device AC = Locking Device & Anti-Static Device	00 = None HG = High Pressure Gas Service

Order Example: (H700666MDBUFA0070000) The Part Number will contain 20 digits.

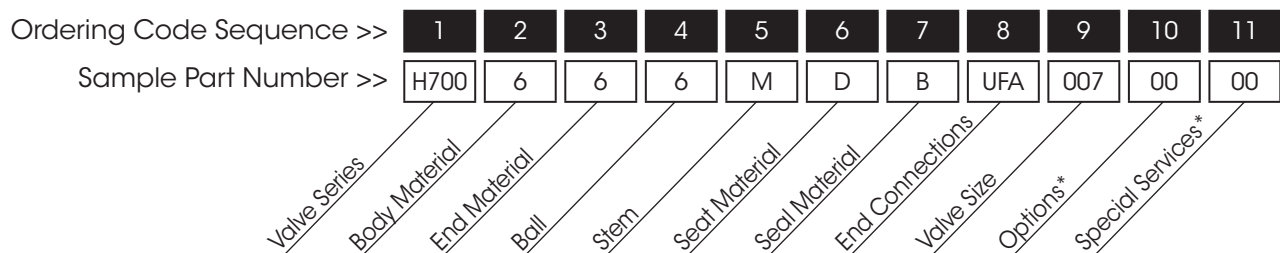

* Not all Options or Special Services available on all ball valves. Consult SVF for additional information.

** Delrin Seats cannot be used for Oxygen Service