

The SVF Series F8 (Standard Port) and FB8 (Full Port) are high performance, three-piece, fire-safe ball valves certified to the latest API-607 and API-608 standards. These valves satisfy a wide range of industrial applications for processing and handling flammable fluids.

SERIES F8/FB8 DESIGN FEATURES

- ✓ Fire-safe certification to API-607
- ✓ Certified to API-608 to meet the additional design, operational and performance Requirements of the Petroleum Refining, Petrochemical Processing and Chemical Processing Industries
- ✓ Secondary metal back up seat
- ✓ Anti-Static stem device
- ✓ Encapsulated body seals to facilitate welding without disassembly
- ✓ Live-loaded stem packing ensures seal-tight pressure containment even under thermal cycling
- ✓ ISO 5211 mounting pad for easy actuation
- ✓ Standard seat material is TFM1600™
- ✓ Blowout proof stem adds safety & reliability

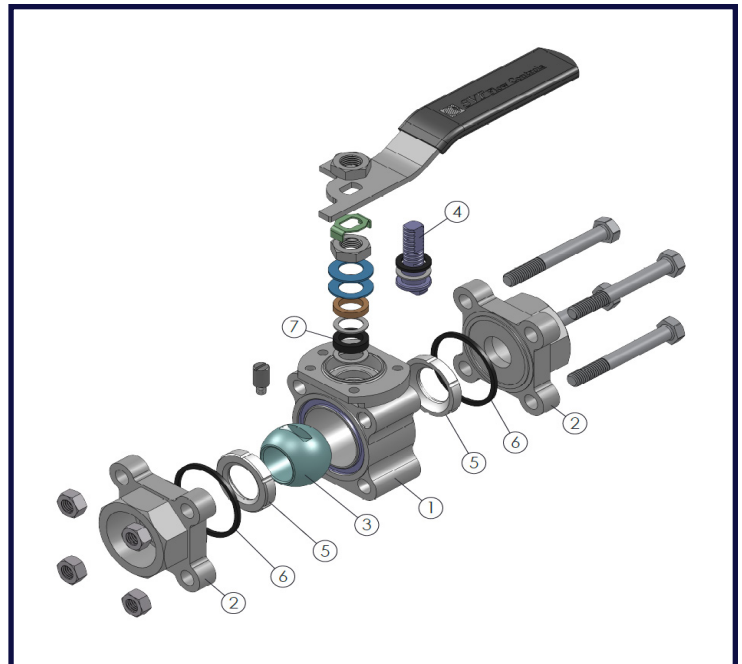

MATERIALS OF CONSTRUCTION

ITEM	DESCRIPTION	MATERIALS SPECIFICATIONS
1	Body	316 Stainless Steel (ASTM A351 - CF8M) Carbon Steel (ASTM A216 - WCB)
2	End Connector	316L Stainless Steel (ASTM A351 - CF3M) Carbon Steel (ASTM A216 - WCB)
3	Ball	316 Stainless Steel (ASTM A351 - CF8M)
4	Stem	316 Stainless Steel (ASTM A276)
5	Seat	TFM1600™
6	Body Seal	GRAFOIL®
7	Stem Seal	GRAFOIL®

SPECIFICATION STANDARDS OF COMPLIANCE

SVF Series F8/FB8 Ball Valves are available in designs that meet the following Industry Standards:

- ANSI
- NACE
- DIN
- ASME
- ASTM
- ISO
- API
- MSS

Contact SVF for specific applications

What do you need today?™

HIGH PURITY
CleanFLOW®

PRO-SPEC
PROCESS SPECIFIC

**QUALITY FLOWS
THROUGH US**

DIMENSIONS, WEIGHT, Cv, TORQUE: F8= Standard Port, FB8= Full Port

Size		A		B		D		L		Weight		Cv	Torque*	
F8	FB8	in.	mm	in.	mm	in.	mm	in.	mm	lbs	kg		in-lbf	Nm
-	1/4"	2.55	65	0.39	10	5.00	127	1.81	46	1.8	0.8	3	45	5
1/2"	3/8"	2.55	65	0.39	10	5.00	127	1.81	46	1.8	0.8	5	45	5
3/4"	1/2"	2.85	73	0.59	15	5.00	127	2.00	51	2.1	1.0	12	45	5
1"	3/4"	3.36	85	0.79	20	5.83	148	2.59	66	3.9	1.8	32	100	11
-	1"	4.15	105	0.98	25	5.83	148	2.76	70	5.2	2.4	57	130	15
1-1/2"	1-1/4"	4.37	111	1.26	32	7.20	183	3.23	82	7.6	3.4	80	280	32
2"	1-1/2"	5.01	127	1.50	38	7.20	183	3.42	87	11	5.0	104	360	41
-	2"	5.71	145	1.97	50	10.51	267	3.78	96	13	5.9	240	560	63

F8/FB8 - PRESSURE/TEMPERATURE CHART

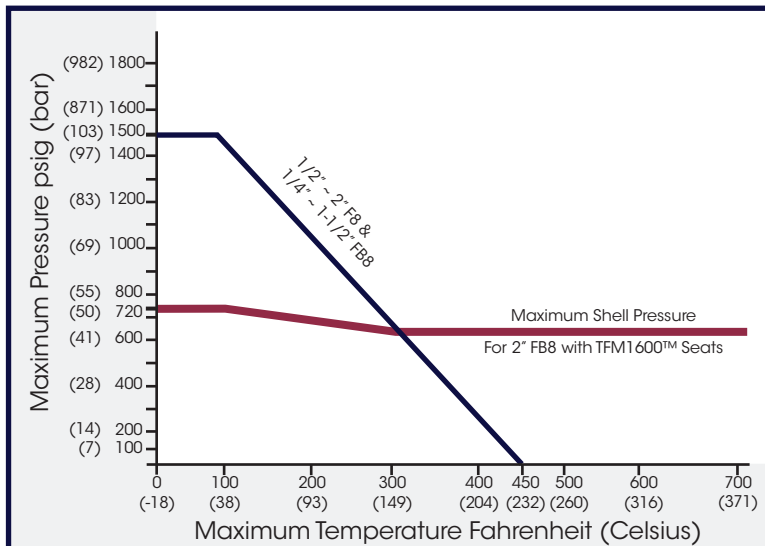

* At full differential pressure for clean fluids with TFM1600™ Seats

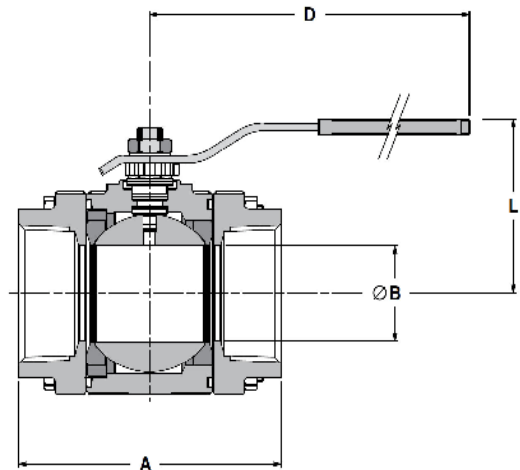

HOW TO ORDER SERIES F8/FB8 BALL VALVES

Please refer to the next page for our comprehensive
How to Order Guide for Series F8/FB8 Ball Valves.

↓ Ordering Code Sequence (Columns 1 thru 11)

1	2	3	4	5	6
SERIES	BODY	ENDS	BALL	STEM	SEAT MATERIAL
F800	4 = Carbon Steel ASTM A216 - WCB	4 = Carbon Steel ASTM A216 - WCB	6 = 316 Stainless Steel ASTM A351 - CF8M	6 = 316 Stainless Steel ASTM A276 - 316	A = TFM1600™
FB80	6 = 316 Stainless Steel ASTM A351 - CF8M	6 = 316L Stainless Steel ASTM A351 - CF3M			

7	8	9	10	11
BODY SEAL	END CONNECTIONS	VALVE SIZE	OPTIONS*	SPECIAL SERVICES*
G = GRAFOIL	SE0 = Threaded Ends (FNPT) SW0 = Socket Weld Ends BW0 = Butt Weld Ends (Schedule 40 Pipe) BWA = Butt Weld Ends (Schedule 10 Pipe) BWC = Butt Weld Ends (Schedule 80 Pipe)	002 ¹ = 1/4" 003 ¹ = 3/8" 005 = 1/2" 007 = 3/4" 010 = 1" 012 = 1-1/4" 015 = 1-1/2" 020 = 2"	00 = None OH = Oval Handle LK = Locking Device SX = ISO Stem Extension AA = Oval Handle & Locking Device AB = Oval Handle & ISO Cast Stem Extension AG = ISO Cast Stem Extension & Locking Device JA = Oval Handle, ISO Cast Stem Extension & Locking Device	00 = None XC = Oxygen Cleaned SF = Degreased (Silicone Free) UH = Vent/Relief Hole ² AE = Oxygen Cleaned & Vent/Relief Hole ² AK = Degreased & Vent Hole ²

Order Example: (F8006666AGSE00100000) The Part Number will contain 20 digits.

Ordering Code Sequence >>	1	2	3	4	5	6	7	8	9	10	11
Sample Part Number >>	F800	6	6	6	6	A	G	SE0	010	00	00
	Valve Series	Body Material	End Material	Ball	Stem	Seat Material	Seat Material	End Connections	Valve Size	Options*	Special Services*

Anti-Static Device is part of the standard assembly of these Valves.

¹ 1/4" and 3/8" Valves are Full Port

² Vent Hole is on the Upstream Side

* Not all Options or Special Services available on all ball valves. Consult SVF for additional information.